

19 | Montgomery



3



2



1



1

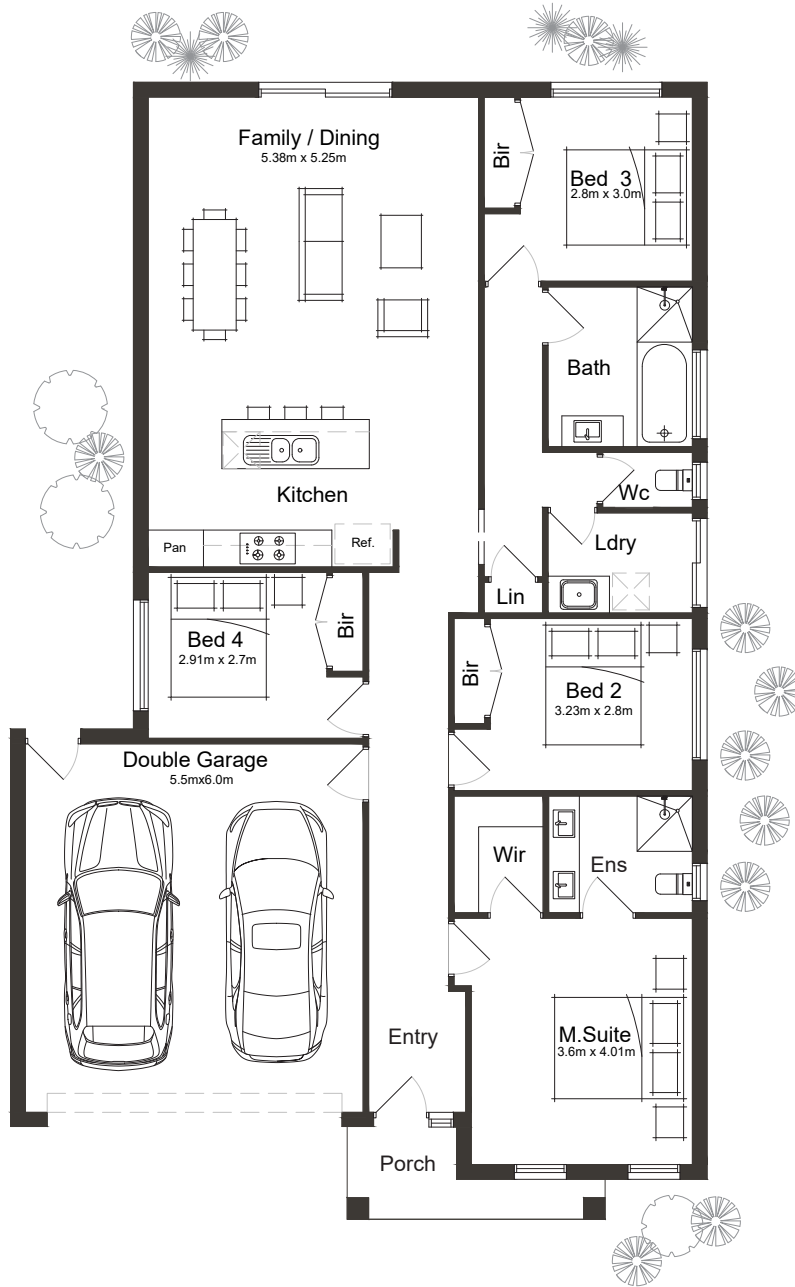

12.5m
Block Width

House Area

Garage	36.24m ²
Portico	4.24m ²
House Area	139.0m ²
Total Area	179.48m ²

Room Dimensions

Family / Dining	5.38m x 5.25m
Master Suite	3.6m x 4.01m
Bedroom 2	3.23m x 2.8m
Bedroom 3	2.8m x 3.0m
Bedroom 4	2.91m x 2.7m
Double Garage	3.5m x 6.0m

SYMMETRIC HOMES

Homes that are more than just walls.

26 COOK STREET
PORT MELBOURNE
VICTORIA 3207

(03) 9676 2409
SYMMETRICHOMES.COM.AU
ABN 68 133 114 628